

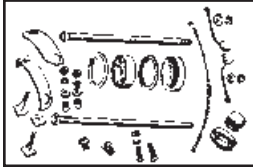

# 2 Brush Generator Repair



**Generator Rebuild Kit.** Complete as shown, all small parts necessary for rebuilding a 6 or 12 Volt, 2-Brush Generator.  
**VT No. 32-0431**

**2-Brush Generator Components available separately.**

VT No.	OEM	Item
32-0164	30012-58	Bolt (2)
32-0234	30426-58	Brush Set
32-0231	29913-82	Brush Set, Hitachi
12-0581	7634	Terminal Nut
12-2120	30280-58	Pole Screw
32-0209	30350-58	6 Volt Brush Holder
32-0210	30450-66	12 Volt Brush Holder
13-0117	30453-58	Brush Spring, 10pk
12-0303	9007	Gear End Bearing
12-0304	9007	As Above (Open)
12-0320	9088	Comm End Bearing w/Seal
10-2553	30148-58	Comm End Cover Bushing
12-0319	9064	End Cover Bearing
12-0902	11004	F Retaining Ring
14-0101	12002	Cover Seal
14-0112	30145-46A	1958-69 Large Seal



**Generator Parts.**

VT No.	#	Item	Years
32-0217	A	Oil Deflector	1958-81
32-0219	B	Washer	1958-69

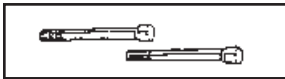

8151-2



**Generator Mounting Screws.**

*For 1936-57 Big Twins OHV*

Chrome	Cadmium	Parkerized
8151-2	8152-2	9679-2
8753-2		

**Generator Screw Kit (Phillips) for 1950-54**

2097-2	2098-2	3 Brush	Stock
--------	--------	---------	-------

*For Big Twin 1958-69 With Hex*

8153-2	8154-2	2 Brush	Stock
7113-2		2 Brush	Acorn
8754-2		2 Brush	Allen

*For 45" 1937-57*

8207-2	8208-2	9712-2	3 Brush	Stock
--------	--------	--------	---------	-------

*For 45" 1958-73*

8209-2	8210-2	2 Brush	Stock
--------	--------	---------	-------

*For 74" & 80" ULH 1930-48*

9108-2	9109-2	9678-2	3 Brush	Stock
--------	--------	--------	---------	-------



**2 Brush Generator Gear Kit** is available as complete installation kit. Kits include gear, deflector nuts. Fits 1958-69 74 FL. 13 Teeth.

VT No.	Item
32-0204	Kit
32-0220	Gear Only



**Replica 2 Brush Field Coils** feature warp-free laminates and heavy copper core winding. Matched pair with lead.

VT No.	OEM	Type	Volt	Brand
32-0229	30201-58A	58/61	6 VT	
32-0230	30201-65 65		12	Accel
32-7599	30201-65 65		12	VT



**2 Brush Generator Gasket** fits 1958-69.  
**VT No. 15-0150**



**Generator End Brush Band** for 1966-80 2-Brush generators replaces 30475-66 with bolt.

VT No.	Finish
32-0199	Chrome
32-0200	Black



**Replica Generator Armatures** feature heavy copper windings on precision shafts with solid copper commutator.

VT No.	OEM	Volt	Model	Brand
32-0224	30851-65A	12V	1965-69 FL	VT
32-0225	30851-61	6V	1961-64 FL	Accel
32-0226*	30851-58 6V		1958-60 FL	VT
32-0222*	30851-65A	12V	1965-69 FL	VT



**Generator Terminal Nuts** replace 7634, on all generators 1930-up, 10 pack.

VT No.	Type
12-0572	Brass
12-0581	Steel with star washer



**2 Brush Generator Hardware Kits** include gaskets and replacement hardware as shown.  
**VT No. 32-0227**



**2-Brush 1958-69 Generator Terminal Kits** include nuts and insulators.  
**VT No. 2127-11**



**2 Brush 1958-80 Sets.** Replaces 30426-58.  
**VT No. 32-0234**

## Tech Tip: 12 V Upgrade

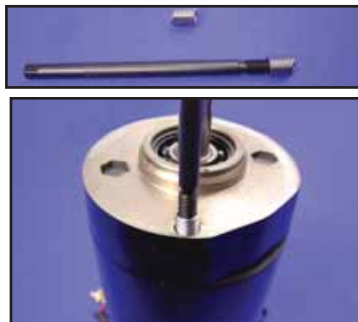

Use Heli Coil 16-0920 kit to convert 12v generators with 5/16 x 24 thread to 1/4 x 20 thread to accept early mount bolt set.