

# Pinion Parts

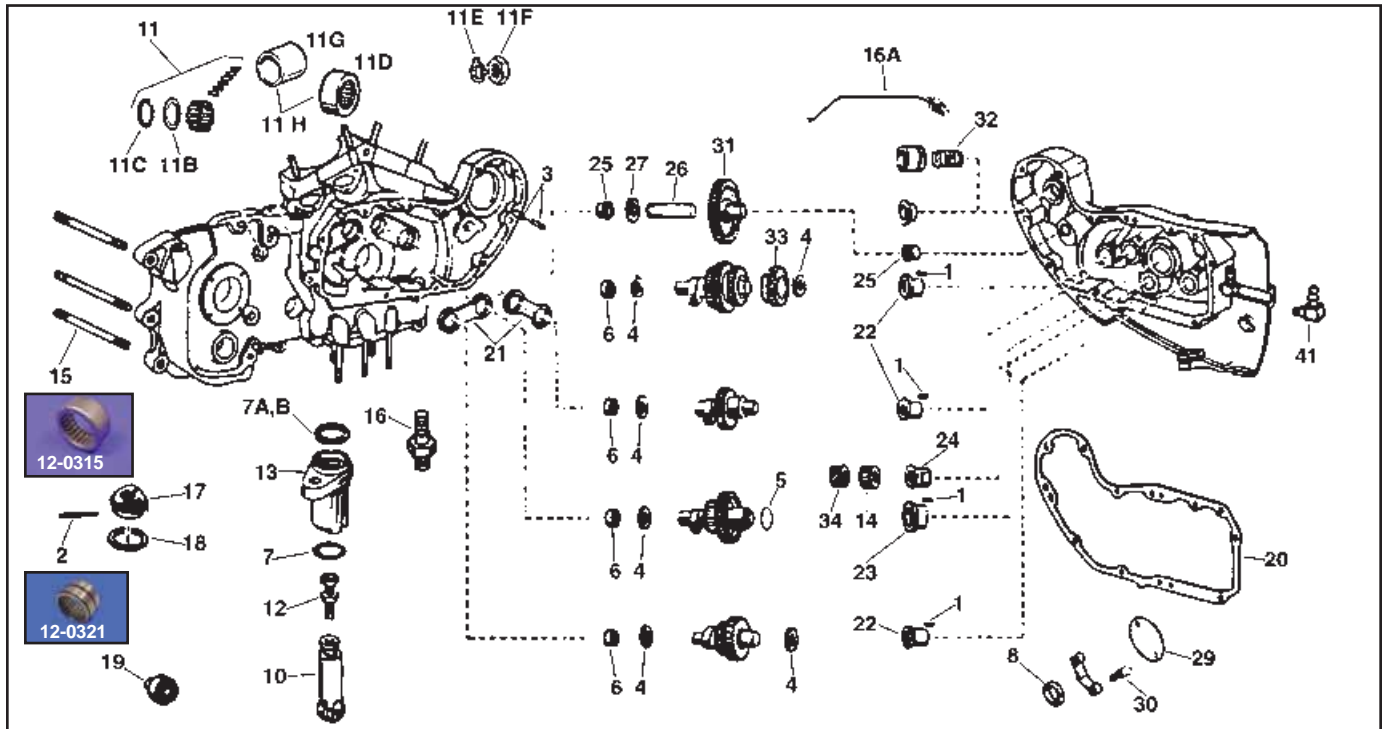

VT No.	#	OEM	Description	Year
12-1184	1	275	Pin Bushing	1954-90
12-1173	2	333	Pin, Strainer	1952-76
12-1172	3	375	Pin, Casing	1957-76
12-0705	4	6769	Shims Cams .007	1952-85
12-0706		6770	As Above .005	1952-85
12-0716		6771	As Above .015	1952-85
12-0717	5	6773	Shim #2 Cam .005	1952-85
12-0718		6775	As Above .010	1952-85
12-1258		6778	As Above .015	1952-85
12-0315	6	9057	Bearing Cam	1952-90
10-2552	6	25598-91	Bushing Cam	1991-up
14-0500	7	11100	O-Ring Block	1952-85
14-0501	7A	11101	O-Ring Pushrod	1979-85
15-0116	7B	17955-36	Cork, Pushrod (12)	1952-E79
14-0100	8	11124	Seal, Cam Cover	1957-up
10-0502	10	18508-52B	Cam Follower STD	1957-86
10-0503		—	Cam Follower .005 O/S	1957-86
10-2536	11	—	Pinion Bearing Kit	1954-76
10-1154	11B	24692-54	Washer	1954-76
12-0913	11C	24701-54	Ret. Ring	1954-76
12-0321	11D	24648-77	Bearing	1977-84
10-2531	11G	24009-77	Race	1977-84
12-0380	11H	—	Bearing w/Race	1985-86
17-0918	11E	7044A	Lock	1979-up
12-0536	11F	7913	Nut	1977-90
12-0577	11F	7916A	Nut	1991-up
10-0517	12	18554-57	Tappet Adjusters	1957-85
10-0522	13	18607-57A	Tappet Block (Jims)	1957-85
10-0182	13	18607-57A	Tappet Block Set	1957-85
12-1394	14	24011-37	Pinion Gear	1957-76
12-1473	14	24011-37	Pinion Gear	1957-76
Note:	14	24059-74	Pinion Gear	1977-up
			See Chart	
12-1151	15	24817-52	Stud (3) Casing	1954-81
12-1150	15	24825-82	Stud (3) Casing	1982-up
34-0571	16	24827-66A	Stud/Intake Block	1965-72
40-0121	16A	24912-52A	Breather Pipe Chr.	1954-82
12-1512	17	24975-37	Oil Strainer	1954-72
15-0339	18	24978-57	Gasket, Strainer	1954-76
12-1511	19	25075-55	Breather Valve	1952-76
15-0121	20	25224-52	Gasket, Cam Cover	1952-80
15-0124		25263-84	Gasket, Cam Cover	1981-85
15-0245		25263-86	Gasket, Cam Cover	1986-90
17-0921	21	25551-58	Cam Thrust Plate	1958-90
10-0709	22	25586-37	Bushing Cam	1952-up
10-2540	22	As Above	.005 O/S	1952-up
10-0710	23	25588-57	Bushing #2 Cam	1952-90
10-2541	23	As Above	.005 O/S	1952-90

VT No.	#	OEM	Description	Year
10-8538	23	25588-91	Bushing #2 Cam	1991-up
10-0712	24	25593-57	Bushing Pinion	1957-76
10-2544		As Above	.005 O/S	1957-76
10-0713	24	25593-74	Bushing Pinion	1977-up
10-0715	25	25597-57	Bushing Idler	1952-85
10-2546	25	As Above	.005 O/S	1952-85
10-2499	26	25787-57	Stud, Idler Gear	1957-85
15-0217	27	25811-11	Washer, Idler Gear	1957-85
10-0197	26+27	—	Idler Stud Kit	1957-85
15-0155	29	32591-70	Gasket, 2 Hole	1970-79
15-0156		32591-80	Gasket, 4 Hole	1980-95
32-0051	30	32601-78	Stud, Ignition	1972-79
12-1451	31	25776-57	Idler Gear	1957-84
13-0106	32	25287-37	Breather Spring	1957-62
12-1400	33	25517-71	Tach Drive Gear	1971-80
12-1290	32A	25265-63	Breather Deflector	1963-78
12-0421	34	26818-37	Oil Pump Drive Gear	1957-76
12-1380	34	26318-75	Oil Pump Drive Gear	1977-87
12-1377	34	26318-88A	Oil Pump Drive Gear	1988-up
17-0519	41	62375-57	Vent Hose Fitting	1970-up
12-0215	42	11219	Oil Pump Drive Key	1988-99
12-0213	43	11204	Rear Intake Key	1980-85



### Cam Cover Gaskets.

GB No.	James	OEM	Fits
15-0339	15-0214	24978-57	1957-81 Oil Strainer
15-0121	15-1078	25224-52A	1954-E81 Cam Cover
15-0124	15-0931	25263-81	1982-85 Cam Cover
15-0245	15-0932	25263-86	1986-90 Cam Cover
—	15-1255	As Above	W/Silicone Bead
15-0308	—	—	1991-99 Cam Cover
—	15-1256	As Above	W/Silicone Bead
—	15-0933	25263-90A	2000-up Cam Cover
15-0385	15-1223	25263-00	2000-up Cam Cvr w/Bead



**Quick Change Cam Gear Gasket & Seal Kit fits XL & Evo motors, includes both cork and quad seals for pushrods to fit all year range.**

GB No.	Year	GB No.	Year
15-0752	1957-81	15-0755	1991-99
15-0753	1982-85	15-1265	2000-03
15-0754	1986-90	15-1266	2004-up

### Cam Cover Screws for Sportster

Chrome Year	Chrome	Cad	Chrome	Year
Acorn	Allen	Stock	Stock	1954-70
—	—	8895-9	8894-9	1971-84
7150-8	8783-8	2062-8	2061-8	—
8865-11	9751-11	—	—	1986-2003
—	37-1202	—	—	2004-up
—	2222-11	—	—	2004-up